

Building a Better National Library

The Reading Room Integration Project

Margy Burn



Objectives

- to create spaces that enhance learning and knowledge creation through easy and intuitive access to collections and resources
- which support efficient and integrated workflows and are responsible, functional and beautiful



Current situation - six reading rooms spread over four floors

- **Ground floor**
 - Main Reading Room – provides access to general published resources, Australian and overseas collections
 - Petherick Reading Room – a facility for scholars; supervised use of rare materials and access to Oral History
- **Lower Ground Floor**
 - Newspapers and Microforms Reading Room
 - Maps Reading Room
- **Second Floor**
 - Pictures and Manuscripts Reading Room
- **Third Floor**
 - Asian Collections Reading Room



What users/readers have told us

- Very high satisfaction
- Appreciate the ambience of Reading Rooms
- Range and depth of collections and information resources
- Calibre of staff
- Breadth of services provided



Issues detracting from overall positive experience

- Crowding at peak times
- Lack of technology facilities, larger tables, access to power
- Demand for more quiet study space
- Need for group work space



Issues detracting from overall positive experience (2)

- Desire to use multiple collection formats simultaneously
- Limited opening hours of Special Collections Reading Rooms



Benefits

- Modernise and improve facilities, improve technology access
- Consistent services from Reading Rooms, intuitive way finding
- Use staff expertise more appropriately, rationalise service delivery
- Build flexibility for the future



Service continuum

- Ground floor - general access for most users. Exhibition galleries, Bookplate restaurant, bookshop
- First floor - services for scholars, supervised use of rare and special collections
- Lower Ground Floor - Infozone next to Paperplate café for informal study



Main Reading Room

- Zoned areas provide spaces for specific purposes
- Integration allows use of multiple formats in same location
- Increased quiet zones
- Enclosed studies for collaborative work
- Space for private consultation with staff
- Extended access to newspapers and family history service



NATIONAL LIBRARY OF AUSTRALIA

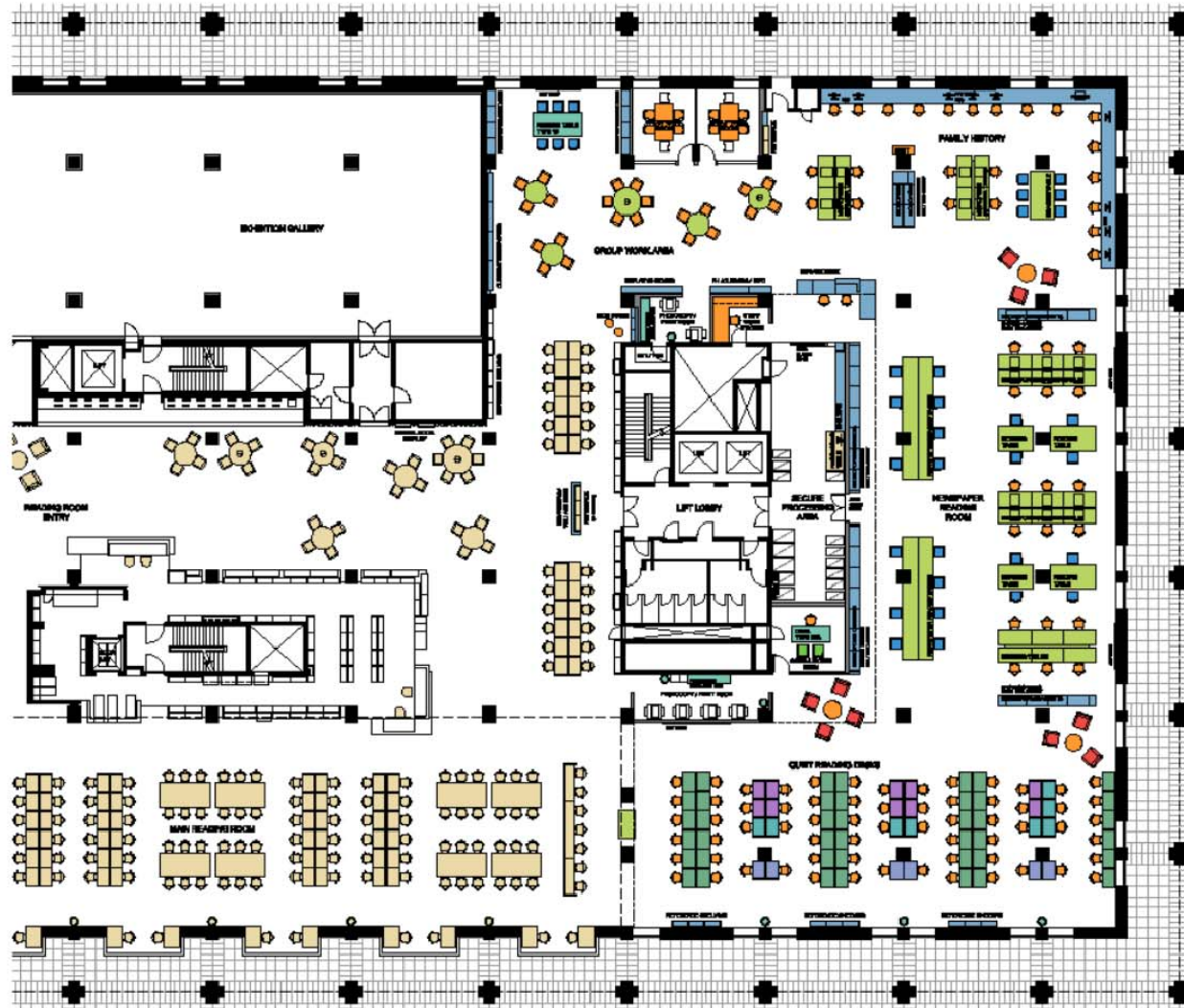

CMD Design & Build Group
 11 Wills Street (Bentley)
 Southport QLD 4215
 Telephone 07 5534 0077
 Fax 07 5534 0072
 Email info@cmdgroup.com.au
 Website www.cmdgroup.com.au

- KEY**
- READING TABLES & CHAIRS
 - NEW ZONE
 - NEW CLAYTON PLANTING
 - NEW LARCH FURNITURE
 - FURNITURE PLACEMENT
 - NEW TABLES
 - NEW READER CHAIR
 - NEW BENTLEY BOOKCASES
 - PROPOSED READER CHAIR TYPE 1 - UNBLENDED
 - PROPOSED READER CHAIR TYPE 2 - UNBLENDED
 - PROPOSED READER CHAIR TYPE 3 - UNBLENDED
 - PROPOSED READER CHAIR TYPE 4 - UNBLENDED
 - MODEL TYPE 1
 - MODEL TYPE 2
 - MODEL TYPE 3
 - MODEL TYPE 4

PROJECT
 NATIONAL LIBRARY OF AUSTRALIA
 READING ROOM REDESIGN
 PROJECT - 01/2010



READING HALL
 MAIN READING ROOM
 LEVEL 0, PROPOSED
 FURNITURE & JOBBERY PLAN

DATE 14/02/2010
REVISED 16/02/2010
DATE 16/02/2010
SCALE 1:500/2/3

3.10



Main Reading Room Ground Floor

Main Reading Room



View from Group Work Area to Family History zone

Main Reading Room



Special Collections Reading Room

- Simultaneous use of multiple collection formats
- Extended access to Pictures, Maps and Manuscripts
- Enclosed spaces for dictation or use of technology for people with disabilities
- Enclosed studies for collaborative work
- Space for private consultation with staff or viewing restricted material
- Self-service photography facility



NATIONAL LIBRARY OF AUSTRALIA

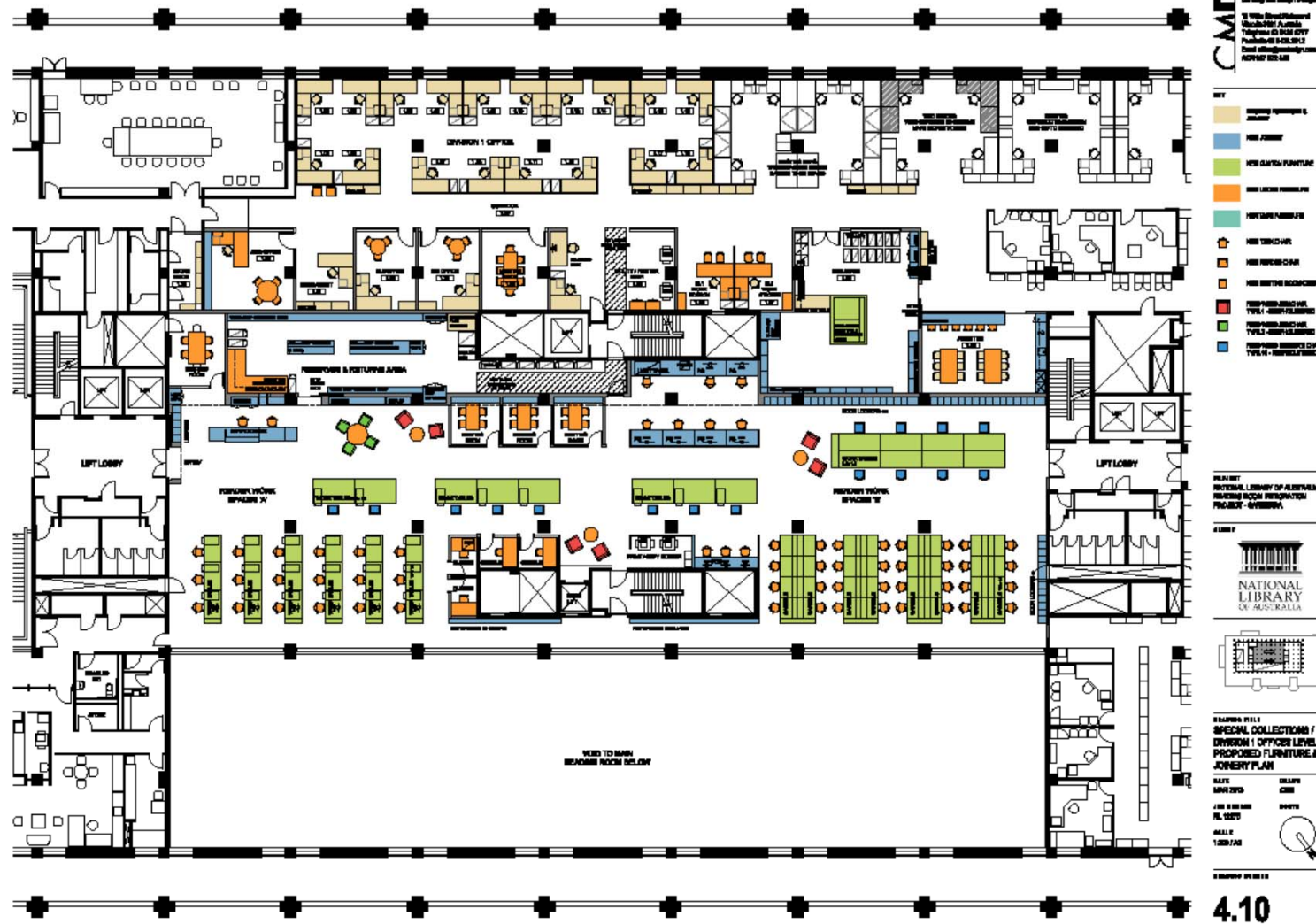

Special Collections Reading Room



View from entry with service desk to the left

Special Collections Reading Room



View from new Petherick area looking back to entry

Paperplate and infozone



View from Paperplate café showing the expanded seating area

Infozone

- Informal study space with flexible furnishing
- Eating and drinking permissible
- Enlarged space for café patrons; breakout space for events
- Self-service lockers



infozone



Seating area expanded into current Maps Reading Room

Other benefits

- Improved facilities for people with disabilities
- Installing energy efficient lighting
- Upgrades to obsolete services - fire systems, electrical, air-conditioning
- Dedicated space for showing collections to special groups, VIP visitors



Margy Burn
Assistant Direct General
Australian Collections & Reader Services
mburn@nla.gov.au

